

Chizel® Wood Panels

UPDATED ↻



In Stock



Echoing the look of heritage hand craftsmanship with a modern balance, the exceptional looking **Chizel® Wood Panels** showcase an articulated level of detail in bespoke patterns, each with a high variation in texture and depth and now is offered with a quick ship program. Crafted from Solid Ash or an MDF option only, these decorative panels highlight the Next New Thing® in our wall surfacing collections.



Wood Veneer – WPFSN 195
MDF only – WPFSN248



Wood Veneer – WPFSN 197
MDF only – WPFSN249



Wood Veneer – WPFSN 199
MDF only – WPFSN250



Wood Veneer – WPFSN 200
MDF only – WPFSN251



Wood Veneer – WPFSN 202
MDF only – WPFSN252



Wood Veneer – WPFSN 206
MDF only – WPFSN253



Wood Veneer – WPFSN 207
MDF only – WPFSN254



Wood Veneer – WPFSN 208
MDF only – WPFSN255



Wood Veneer – WPFSN 209
MDF only – WPFSN256



SEMMA, New York, NY
Wid Chapman Architects
Featuring CHIZEL® Wood Panels – WPFSN195
[View collection webpage for additional project images](#)

[View collection web page for the complete offering including additional product options, corresponding Spec ID# and updates.](#)

SPECIFICATIONS

SIZE: 47.25" x 94.5" with a 2' x 2' nominal repeat; **WPFSN202 only:** 2' x 4' nominal repeat

THICKNESS: 3/4" overall including backing

FINISH: **Wood Veneer:** Fumed; **MDF only:** Routed MDF

SPECIES: **Wood Veneer:** Ash

CONSTRUCTION: 1/8" Fumed Ash Veneer with 5/8" balanced MDF substrate or available in an MDF option only

APPLICATION: Walls, Architectural Millwork, Furniture and Fixture Components, Doors

INSTALLATION: Z-Clip

- Can contribute to LEED®
- Class A Fire Rating **upon request**
- In Stock products are subject to availability
- Please note that variations in color and texture may occur due to the nature of the material

INSTALLATION METHOD

The preferred method of installation is with Z-clips.

Blind fastening methods are the preferred means of installation due to the fact that it allows for prefinished panels to be delivered and installed without damage to the face.

Z-clips generally allow for closer spacing to the wall, approximately 3/16" between the wall surface and the back of a panel. When applying a Z-clip to the back of a panel the relief of the pattern, position and length of the screws used must be taken into consideration in order not to damage the face of the panel.

Wall mounted clips should be secured into the aluminum or wood studs within the wall structure and not fastened only through the drywall or sheetrock unless noted by Architect.

A minimum of 4 attachments points is required over a 94.5" height. **(1) 6" from top (1) 6" from bottom then equal spacing for remaining (2) clips.**

Clearance must be considered between the top of the panel and the ceiling to allow the panel to be lifted and dropped onto the cleat or Z-clip (1 1/2").

Never use an adhesive to fix the two parts of the cleat together. MDF is a wood product and will expand and contract due to changes in temperature and humidity. Taking this into account the panels should be allowed to "float" on the clips.

Wood and veneered products are warranted for performance within a range of environmental conditions as specified by the Architectural Woodwork Institute (AWI), and in accordance with approved industry standards for installation. geographic region and must be considered while engineering the installation.

When applying a Z-clip to the back of a panel the relief of the pattern, position and length of the screws used must be taken into consideration in order not to damage the face of the panel.

The same consideration for the panel about, the relief of the pattern, position and length of the screws used, must be taken into consideration in order not to damage the face of the panel.

It is the responsibility of the contractor to engineer the installation for its specific application. The following illustrations demonstrate several types of hanging methods.

Panel installs with a butt joint between panels.

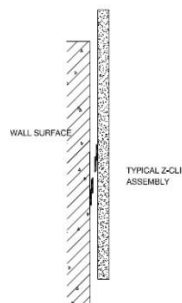

MAINTENANCE

Clean-up recommendations: forced air; a regular dusting with a soft cloth or a feather duster.

WARRANTY

5 year limited commercial warranty

TECHNICAL DATA

- The panels are thermo-fumed (which is the finish) Ash (SPECIES) Please note that variations in color and texture may occur due to the nature of the material – No additional finishing is needed unless the specifier wants to adjust the color. In that case an oil can, be topically added on site or in millworkers shop. ASI recommended oil is the Rubio Monocoat system. We recommend a sample to be sent to the designer/millworker to TEST this process prior to doing so on site.
- Species is Ash – no other species of wood is available
- Custom sizes are available – standard is 47.25" x 94.5" with a tiling repeat on all patterns
- Panels are tiling (right-left; top-bottom) pattern matching between panels
- 1/8" fumed ash veneer with 5/8" balanced MDF substrate or available in an MDF option only – overall thickness is 3/4"
- Class A Fire Rating **upon request.**
- Trim of fumed ash WPFSN224 available upon request.