

Crossfuse® Wood Panels



Crossfuse® Wood Panels are a myriad of handcrafted three-dimensional patterns defined by masterful construction and exceptional design. Comprised of reclaimed wood species, including Teak, Ipe, Ironwood and Walnut veneers, this collection is also sustainable. Patterns and species are interchangeable and are also available in HPL laminates over MDF.



Wood Grain Laminate - WPFSN095



Ironwood - WPFSN096



Ironwood - WPFSN097



Walnut - WPFSN098



Ironwood - WPFSN102



Ipe - WPFSN103



Ipe - WPFSN104



Pine/Oak - WPFSN060

View collection web page for the complete offering including additional product options, corresponding Spec ID# and updates.

SPECIFICATIONS

SIZE: 4' x 8' standard; Custom sizes available

THICKNESS: **WPFSN095:** 15.88mm - 25.4mm ($\frac{5}{8}$ " - 1"); **WPFSN096:** 25.4mm - 31.75mm (1" - 1 $\frac{1}{4}$ "); **WPFSN097:** 22.23mm - 28.58mm ($\frac{7}{8}$ " - 1 $\frac{1}{8}$ "); **WPFSN098** and **WPFSN104:** 15.88mm - 28.58mm ($\frac{5}{8}$ " - 1 $\frac{1}{8}$ "); **WPFSN102:** 19.05mm - 25.4mm ($\frac{3}{4}$ " - 1"); **WPFSN103:** 19.05mm - 31.75mm ($\frac{3}{4}$ " - 1 $\frac{1}{4}$ ") including backing; **WPFSN060:** 25.4mm - 44.5mm (1" - 1 $\frac{3}{4}$ ")

CONSTRUCTION: Veneered Black MDF mounted to MDF substrate; **WPFSN060:** MDF Substrate with finish layer of Solid Wood and Wood Veneers

APPLICATION: Wall, Architectural Millwork, Furniture Components

SPECIES: Teak, Ipe, Ironwood and Walnut veneers; Custom finishes offered **WPFSN095:** shown in Wood Grain Laminate; shown in Charred Pine/Oak

FINISH: Finished wood veneer or HPL laminates; **WPFSN060:** Prefinished

INSTALLATION: Z-Clip or hanger cleats

- Can contribute to LEED®
- This Handcrafted collection may have slight variations, please allow a tolerance of $\frac{1}{16}$ " - $\frac{1}{8}$ " spacing between panels
- Please note that variations in color and texture may occur due to the nature of the material

INSTALLATION METHOD

The preferred method of installation is with Z-clips.

Blind fastening methods are the preferred means of installation due to the fact that it allows for prefinished panels to be delivered and installed without damage to the face.

Z-clips generally allow for closer spacing to the wall, approximately 3/16" between the wall surface and the back of a panel. When applying a Z-clip to the back of a panel the relief of the pattern, position and length of the screws used must be taken into consideration in order not to damage the face of the panel.

Wall mounted clips should be secured into the aluminum or wood studs within the wall structure and not fastened only through the drywall or sheetrock unless noted by Architect.

A minimum of 4 attachments points is required over a 96" height. **(1) 6" from top (1) 6" from bottom then equal spacing for remaining (2) clips.**

Clearance must be considered between the top of the panel and the ceiling to allow the panel to be lifted and dropped onto the cleat or Z-clip (1 1/2").

Never use an adhesive to fix the two parts of the cleat together. MDF is a wood product and will expand and contract due to changes in temperature and humidity. Taking this into account the panels should be allowed to "float" on the clips.

Wood and veneered products are warranted for performance within a range of environmental conditions as specified by the Architectural Woodwork Institute (AWI), and in accordance with approved industry standards for installation. geographic region and must be considered while engineering the installation.

When applying a Z-clip to the back of a panel the relief of the pattern, position and length of the screws used must be taken into consideration in order not to damage the face of the panel.

The same consideration for the panel about, the relief of the pattern, position and length of the screws used, must be taken into consideration in order not to damage the face of the panel. It is the responsibility of the contractor to engineer the installation for its specific application. The following illustrations demonstrate several types of hanging methods.

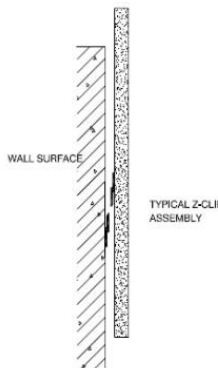

MAINTENANCE

Surface should be kept clean with a dry rag or duster to wipe clean.

WARRANTY

Material is to be free from defect upon delivery.
Please note that variations in color and texture may occur due to the nature of the material.

TECHNICAL DATA

Please contact sales@archsystems.com